

PREPARED FOR:
BRIAN DAHME
913 N. PHEASANT WAY
ELKHORN, WI 53121

PLAT OF SURVEY

-OF-
LOT 33 HEATHERSTONE OF ELKHORN, A SUBDIVISION LOCATED IN
THE NORTHEAST 1/4 AND SOUTHEAST 1/4 OF SECTION 25, TOWN 3
NORTH, RANGE 16 EAST, CITY OF ELKHORN, WALWORTH COUNTY,
WISCONSIN.

KROTT SURVEYING INC.

N3705 WILLOW BEND LANE
LAKE GENEVA WI. 53147
PHONE # (262)248-3697
FAX # (262)249-0639

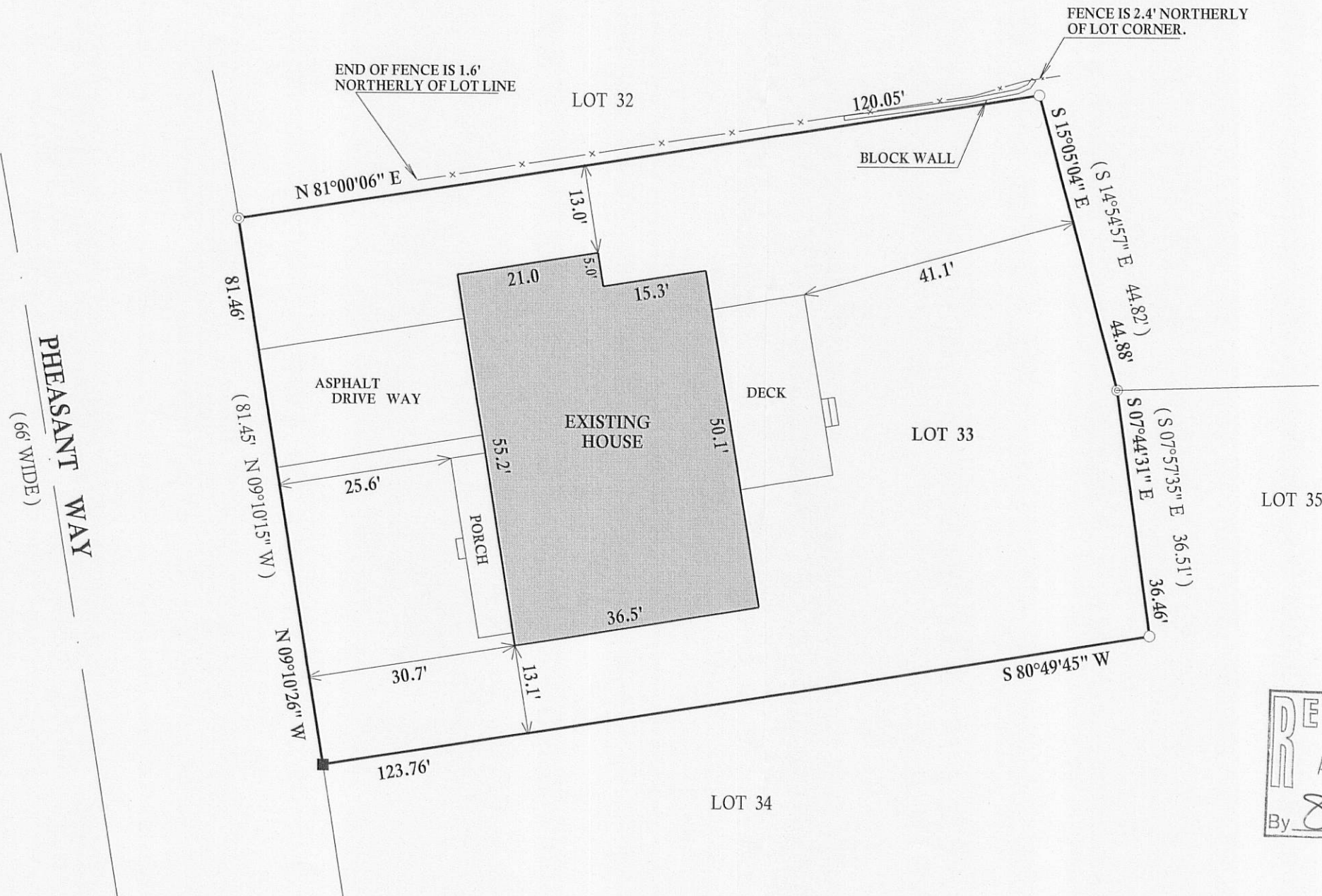

LEGEND

- ⊙ FOUND 2" DIA. IRON PIPE
- FOUND 1" DIA. IRON PIPE
- FOUND IRON BAR
- SET IRON BAR
- (xx) RECORDED AS

JOB #11-044 TAX ID # YHE00033

I have surveyed the above-described property and the above map is a true representation thereof and shows the size and location of the property, its exterior boundaries, the location and dimensions of all structures thereon, fences apparent easements and roadways and visible encroachments, if any.

This survey is made for the exclusive use of the present owners of the property, and also those who purchase, mortgage, or insure the title thereto within one (1) year from date hereof, and as to them I warrant the accuracy of said survey map.

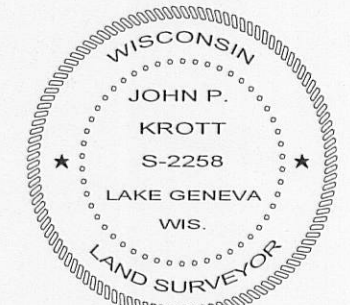
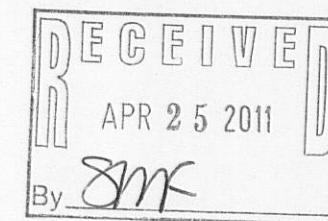
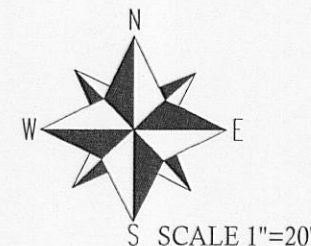

DATED THIS 29th, DAY OF MARCH, 2011

John P. Krott

JOHN KROTT S - 2258
Wisconsin Registered Land Surveyor
(original if signed in red)

004-2311